

# INSTALLATION AND SERVICE MANUAL

For Installation of Steamer Wall Light LED & Accessories  
Model. USE-90002,USE-90012,USE-90022,USE-90032 & UA30160

## PRODUCT DRAWING (DIMENSIONS)

## SUITABLE FOR WET LOCATIONS

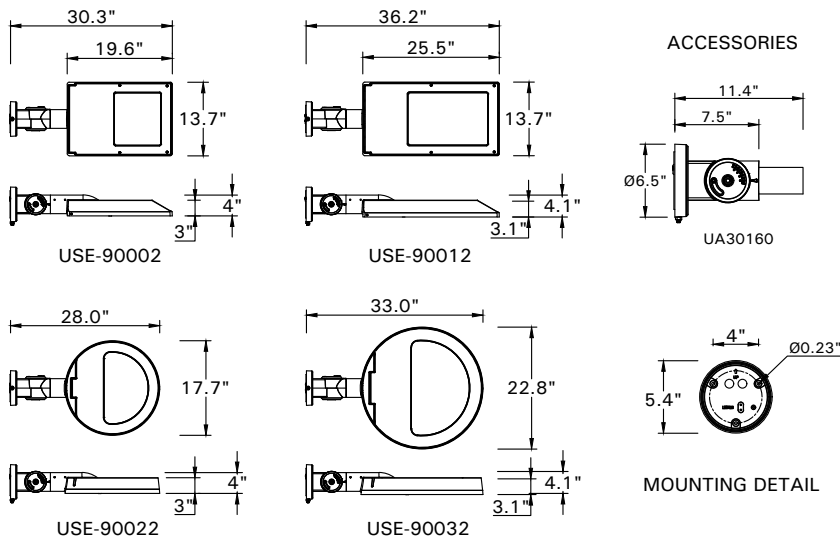

1

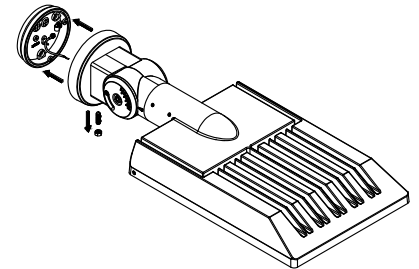

Remove The Fixture part

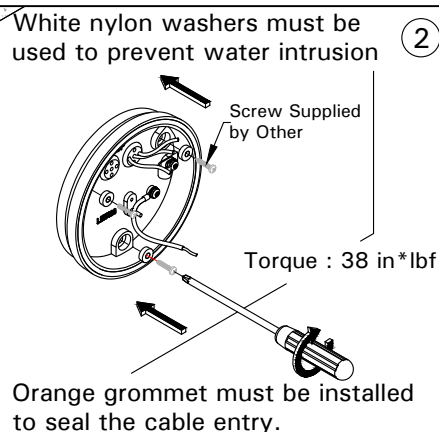

2

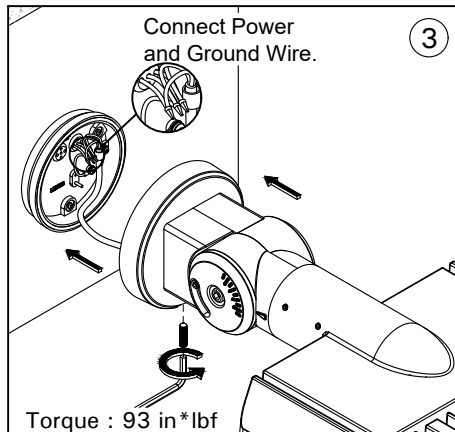

3

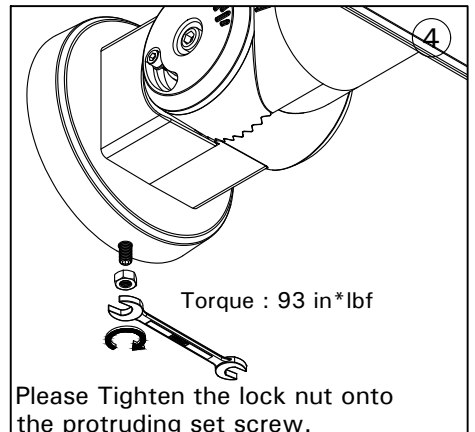

4

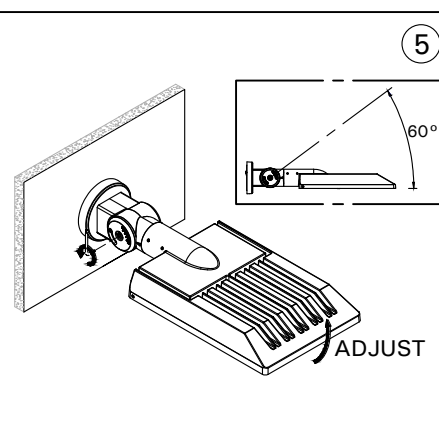

5

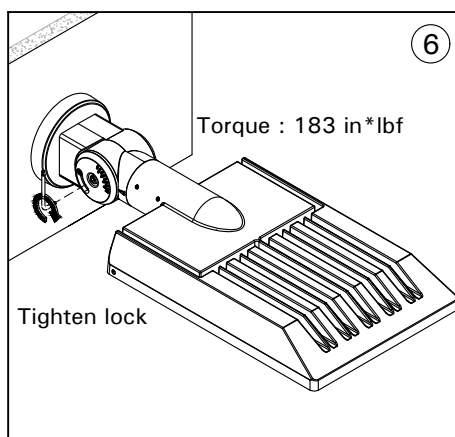

6

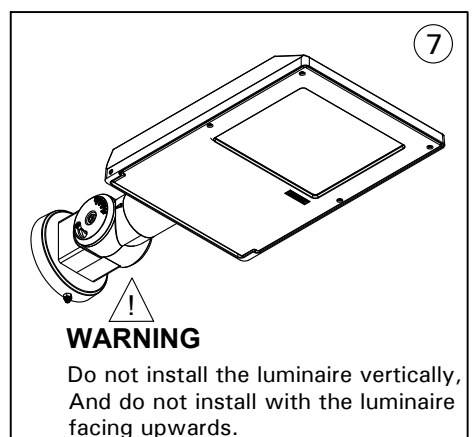

7

### Notice to installer :

**WIRING INSTRUCTIONS** Warning : RISK OF FIRE AND ELECTRICAL SHOCK. : FIXTURE MUST BE INSTALLED BY A QUALIFIED ELECTRICIAN ONLY>FIXTURE IS INTENDED FOR INSTALLATION IN ACCORDANCE WITH THE NATIONAL ELECTRICAL CODE, LOCAL AND FEDERAL CODE SPECIFICATIONS. DISCONNECT POWER BEFORE SERVICING.

**Ligman Lighting USA**

7144 NE Progress Court, Hillsboro  
Oregon, 97124, USA  
Tel : 503 645 0500 | Fax : 503 645 8100